

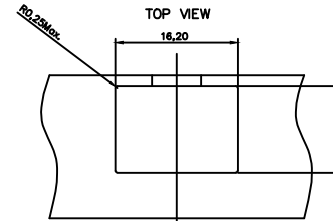

THIS IS A RoHS COMPLIANT COMPONENT/PRODUCT.

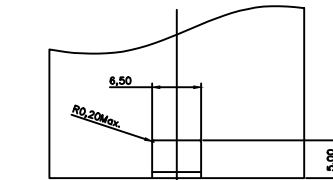

FRONT VIEW
RECOMMEND PANEL LAYOUT

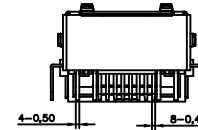
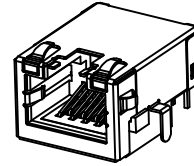
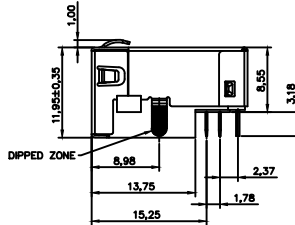
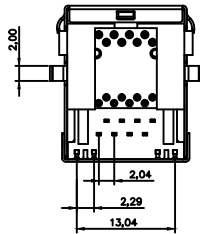
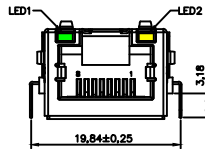
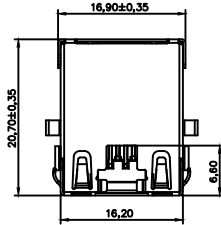
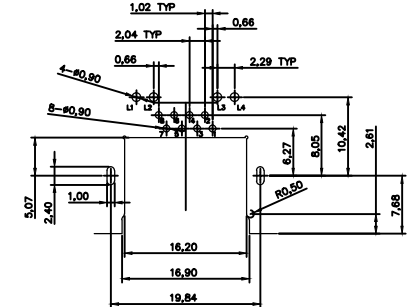

RECOMMENDED PCB LAYOUT (COMPONENT SIDE VIEW) TOLERANCE: ±0.05 [0.002]

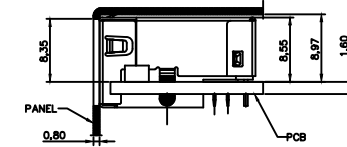

SIDE VIEW SHOWING WITH PANEL AND PCB

NOTES:

ELECTRICAL:

- VOLTAGE RATING : 125 VAC.
- CURRENT RATING : 1.25AMP.
- INSULATION RESISTANCE : 500 MEGOHMS MIN.
- DIELECTRIC STRENGTH : 1000 VAC RMS 60Hz, 1MIN.

MECHANICAL:

- HOUSING MATERIAL : LCP BK. UL94V-0.
- INSERT MATERIAL : LCP BK. UL94V-0.
- CONTACT MATERIAL : PHOS BRONZE C5210-EH T=0.30mm, GOLD FLASH PLATING AT CONTACT AREA NICKEL 30u"~80u" OVER ALL.
- SHIELD : STAINLESS STEEL WITH TIN-DIP ON SOLDER TABS.
t=0.20 mm.
- OPERATING LIFE : 750 CYCLES MIN.
- PCB RETENTION PRE-SOLDER : 1 LB MIN.
- PCB RETENTION POST-SOLDER : 10 LBS MIN.

ENVIRONMENTAL:

- STORAGE : -40°C TO +85°C.
 - OPERATION : -40°C TO +85°C.
- MATES WITH MODULAR PLUG CONFORMING TO TIA-1096-A.
PART NUMBER : K371X-088-XX

- 1-3u" 2-6u" 3-15u" 01-LCP BK.
4-30u" 5-50u" 7-Gold flash

LED DISPLAY		
PART NO.	LED1	LED2
K371X-088-01	GREEN L1	YELLOW L3

ΔX0	0089000	NEW DESIGN	ANDY	101624
MARK	ECN-NO.	REVISION RECORD	DRAWN	DATE
	UNLESS OTHERWISE SPECIFIED TOLERANCE		SCALE	CHECKED
	Dimension Range	Tolerance	2/1	APPROVED
	X.X	±0.30	UNIT	
	X.XX	±0.25	mm	
X.XXX	±0.10	SIZE	A3	SHEET 1/1
Contact Technology Co., Ltd.		ANGLE	±5°	
Material/Plated/Notes		NAME		
SEE NOTE		Cat.6A SIDE ENTRY PCB FTP JACK, 8P		
Tooling No.		PART NO.	SEE NOTE	REV. 0
		DOC. NO.	KK370A088	