

RoHS

THIS IS A RoHS
COMPLIANT
COMPONENT/
PRODUCT.

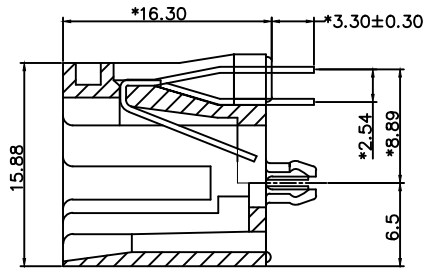

SECTION A-A

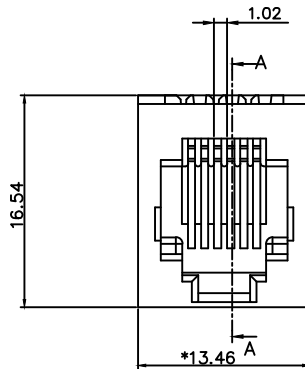
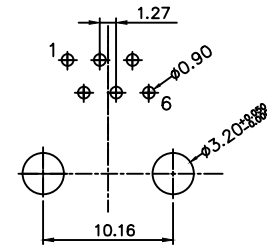
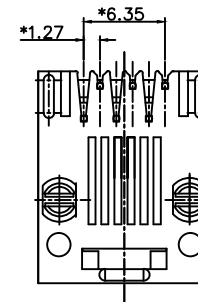

PC Board layout
Component Side Shown

NOTES:

ELECTRICAL:

1. VOLTAGE RATING : 125 VAC MIN.
2. CURRENT RATING : 1.5 AMP MIN.
3. CONTACT RESISTANCE : 30 MILLIOHMS MAX.
4. INSULATION RESISTANCE: 1000 MEGOHMS MIN @ 500 VDC.
5. DIELECTRIC STRENGTH : 750 VAC 50Hz, 1MIN.

MECHANICAL:

1. HOUSING MATERIAL : POLYESTER OR HIGH TEMP. UL94V-0
2. CONTACT MATERIAL : PHOSPHOR BRONZE $\phi=0.46$ mm
3. PLATING : GOLD PLATING OVER NICKEL.
4. OPERATING LIFE : 750 CYCLES MIN.
5. PCB RETENTION PRE-SOLDER : 1 LB MIN.
6. PCB RETENTION POST-SOLDER: 10 LBS MIN.

ENVIRONMENTAL:

1. STORAGE : -40°C TO +85°C.
 2. OPERATION: -40°C TO +85°C.
- MATES WITH MODULAR PLUG CONFORMING TO TIA-1096-A.

PART NUMBER: N311X-044-XX

1- 3u" 2- 6u" 3- 15u"
4- 30u" 5- 50u" 7- 1u"
B-0.5u" D-32u"(0.8um)

- 01-6P4C HIGH TEMP. W/O PANEL STOP BK.
- 02-6P6C HIGH TEMP. W/O PANEL STOP BK.
- 03-6P6C HIGH TEMP. W/ PANEL STOP BK.
- 04-6P6C HIGH TEMP. W/O PANEL STOP COOL GRAY
- 05-6P6C HIGH TEMP. W/ PANEL STOP GRAY (3U)
- 06-6P6C HIGH TEMP. W/O PANEL STOP GRAY (3U)
- 07-6P4C POLYESTER W/ PANEL STOP BK.
- 08-6P2C HIGH TEMP. W/O PANEL STOP BK.
- 09-6P4C POLYESTER W/ PANEL STOP BK.
- 10-6P2C POLYESTER W/ PANEL STOP BK.
- 11-6P2C POLYESTER W/O PANEL STOP COOL GRAY(3U)
- 12-6P4C POLYESTER W/O PANEL STOP COOL GRAY(3U)
- 13-6P4C PA9T W/ PANEL STOP ORANGE(RAL2003)
- 14-6P2C HIGH TEMP. W/O PANEL STOP COOL GRAY(3U)
- 15-6P2C POLYESTER. W/O PANEL STOP GREEN(340C)
- 16-6P2C POLYESTER W/O PANEL STOP BK.
- 17-6P4C PA9T. W/O PANEL STOP PURPLE(7441C)
- 18-6P4C PA9T. W/O PANEL STOP BK.

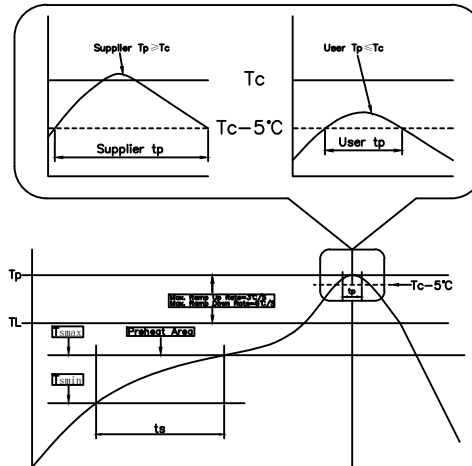

Table 5-2 Classification Rerflow Profiles

| Profile Feature | Pb-Free Assembly |
|---|--------------------------------------|
| Preheat & Soak Temperature min (Tamin) Temperature max (Tamax) Time (Tamin to Tamax) (Tts) | 150°C 200°C 60-120 seconds |
| Average ramp-up (1) Tamin to Tp | 3°C/seconds max. |
| Liquidous temperature (2) Time at liquidous (3) | 217°C 60-150 seconds |
| Peak postbody temperature (4)* | See classification temp in table 4.2 |
| Time (tp)** within 5% of the specified classification temperature (Tc) | 30* seconds |
| Average ramp-down rate (Tp to Tamin) | 6°C/seconds max. |
| Time 25°C to peak temperature | 8 minutes max. |

| | | | | | |
|------------------------------|---------|--------------------------------------|-----------|-----------|----|
| △ X0 | 0006000 | NEW DESIGN | Andy | 020118 | |
| MARK | ECN-NO. | REVISION RECORD | DRAWN | DATE | |
| | | UNLESS OTHERWISE SPECIFIED TOLERANCE | SCALE | CHECKED | |
| | | Dimension Range Tolerance | 2.5/1 | APPROVED | |
| | | X.X | ±0.20 | UNIT | mm |
| | | X.XX | ±0.15 | SIZE | A3 |
| Contact Technology Co., Ltd. | | ANGLE | ±5° | SHEET 1/1 | |
| Material/Plated/Notes | | NAME | | | |
| SEE NOTE | | TOP ENTRY PCB JACK, ROUND PIN | | | |
| Tooling No. | 8000931 | PART NO. | SEE NOTE | REV. A | |
| | | DOC. NO. | NN310A044 | | |