

THIS IS A RoHS COMPLIANT COMPONENT/PRODUCT.

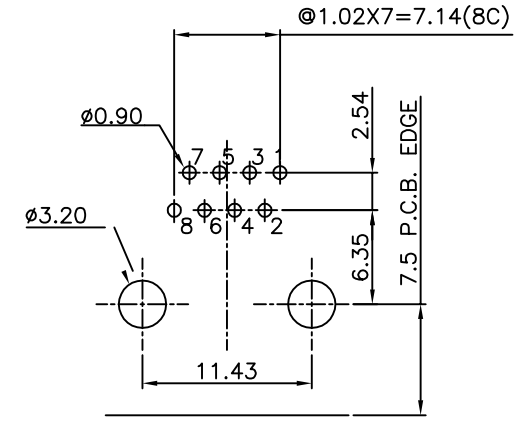

PCB Thickness=1.60mm  
PC Board Layout Component Side Shown

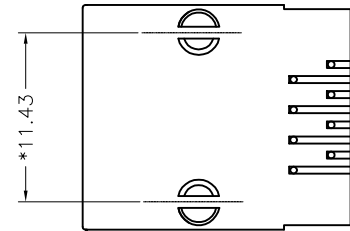
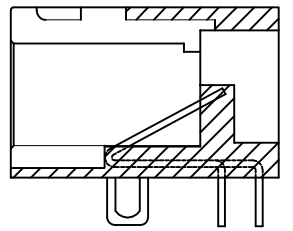
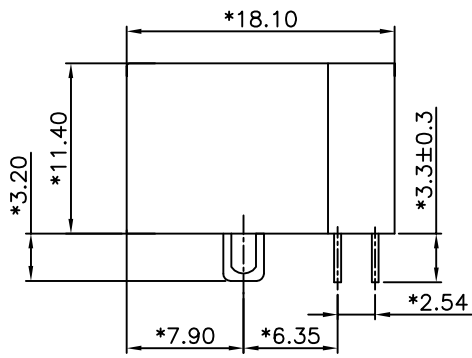
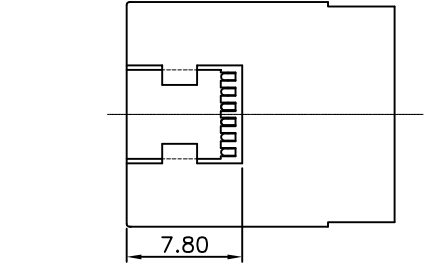
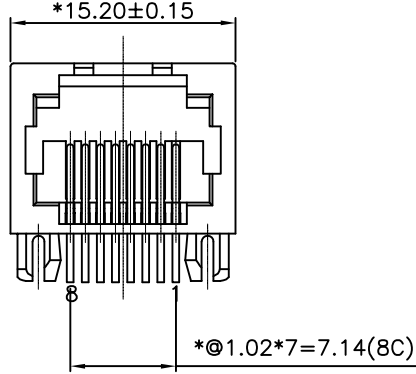

**NOTES:**

**ELECTRICAL:**

1. VOLTAGE RATING : 125 VAC RMS.
2. CURRENT RATING : 1.5 AMP.
3. CONTACT RESISTANCE : 45 MILLIOHMS MAX.
4. INSULATION RESISTANCE: 1000 MEGOHMS MIN @ 500 VDC.
5. DIELECTRIC STRENGTH : 1000 VAC RMS 60Hz, 1MIN.

**MECHANICAL:**

1. HOUSING MATERIAL : HIGH TEMP OR POLYESTER. 30%G.F UL94V-0
2. CONTACT MATERIAL : PHOSPHOR BRONZE  $\phi$ 0.46mm.
3. PLATING : GOLD PLATING OVER NICKEL 30~80u'
4. OPERATING LIFE : 750 CYCLES MIN.
5. PCB RETENTION PRE-SOLDER : 1 LB MIN.
6. PCB RETENTION POST-SOLDER: 10 LBS MIN.

**ENVIRONMENTAL:**

1. STORAGE : -40°C TO +85°C.
2. OPERATION: -40°C TO 85°C.

MATES WITH MODULAR PLUG CONFORMING TO FCC PART 68, SUBPART F.

ROHS PART NUMBER: K331X-011-XX

- |        |              |                      |
|--------|--------------|----------------------|
| 1-3u"  | 2-6u"        | 01-1,2,3,6PIN PBT BK |
| 3-15u" | 4-30u"       | 02-8C PBT BK         |
| 5-50u" | 7-GOLD FLASH | 03-8C PBT YL 114C    |

$\Delta$ X1	000000	ADD P/N	SOULE	102819
$\Delta$ X0		NEW DESIGN	Kelvin	091214
MARK	ECN-NO.	REVISION RECORD	DRAWN	DATE
	UNLESS OTHERWISE SPECIFIED TOLERANCE		SCALE	CHECKED
	Dimension Range	Tolerance	UNIT	APPROVED
	X.X	$\pm$ 0.20	mm	
	X.XX	$\pm$ 0.15		
X.XXX	$\pm$ 0.10	SIZE	A3	SHEET
ANGLE	$\pm$ 5°			
Material/Plated/Notes	NAME			
SEE NOTE	11.4 SIDE ENTRY 8P DEEP TYPE			
Tooling No.	PART NO.	SEE NOTE	REV.	
	DOC. NO.	KK330A011	1	