

RoHS

THIS IS A RoHS COMPLIANT COMPONENT/PRODUCT.

NOTES:

ELECTRICAL:

1. VOLTAGE RATING : 125 VAC.
2. CURRENT RATING : 1.5 AMP.
3. CONTACT RESISTANCE : 30 MILLIOHMS MAX.
4. INSULATION RESISTANCE: 1000 MEGOHMS MIN. @ 500 VDC.
5. DIELECTRIC STRENGTH : 1000 VAC 60Hz, 1MIN.
6. OPERATING: 1500 CYCLES MIN.

MECHANICAL:

1. HOUSING MATERIAL : HIGH TEMP. UL94V-0.
2. CONTACT MATERIAL : PHOSPHOR BRONZE t=0.30mm.
3. PLATING : GOLD PLATING OVER NICKEL.
4. PCB RETENTION PRE-SOLDER : 1 LB MIN.
5. PCB RETENTION POST-SOLDER: 10 LBS MIN.

ENVIRONMENTAL:

1. STORAGE : -40°C TO +85°C.
2. OPERATION: : -40°C TO +85°C.
3. WAVE SOLDERING TEMPERATURE: 255~265°C (5~10 SECONDS)
4. MATES WITH MODULAR PLUG CONFORMING TO TIA-1096-A.

PART NUMBER: N3J1X-137-XX

- 1-3u" 2-6u" —
- 3-15u" 4-30u"
- 5-50u"

- 01- W/TOP&SIDE TABS BK.
- 02- W/O TABS BK.
- 03- W/TOP TABS BK.
- 04- W/O TABS BK. W/O PEG
- 05- W/O TABS PA10T BK.
- 06- W/TOP&SIDE TABS BK. (T&R)
- 07- W/O TOP&SIDE TABS BK.
- 08- W/TOP&SIDE TABS BK.(Tray)
- 09- W/O TABS PA9T BK.

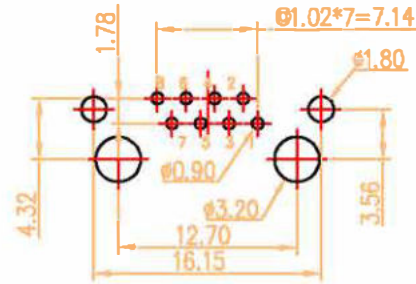
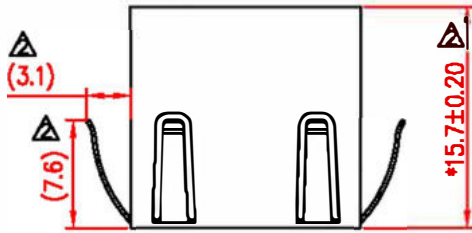

PCB Layout
Component Side Shown

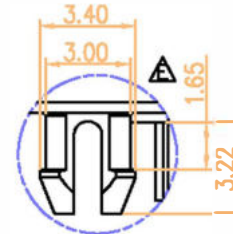
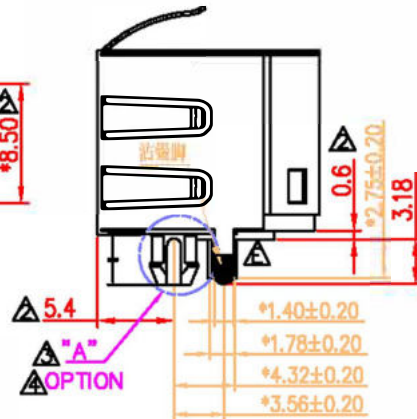
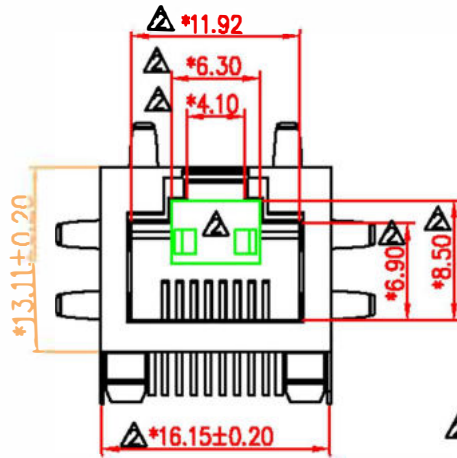

DETAIL "A"
SCALE: 2:1

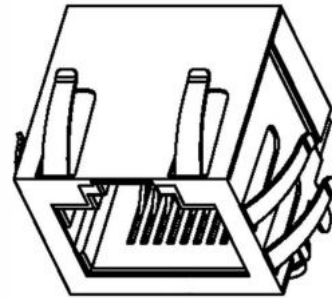
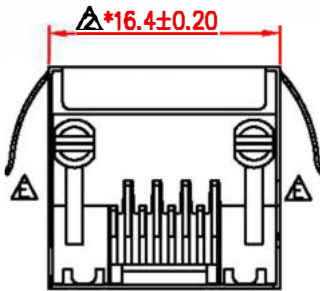

△ X 4		Adjust the surface	Andy	081121'
△ X 1		ADD NEW P/N	Joy	080221'
△ X 1		Apply for shipping number	SOULE	102419'
△ X 1		ADD NEW P/N	ANDY	062219'
△ X 1		ADD NEW P/N	GRACE	022618'
△ X 1	0006600	ADD NEW P/N	SELINA	082817'
△ X 2	0006600	ADD NEW P/N	DORIS	091316'
△ X 2	0006600	ADD DETAIL OF PEG	DORIS	012315'
△ X 15	0006600	MODIFY DRAWING	ROCK	080712'
△ X 1	0006600	ADD NEW P/N	PETER	081511'
△ X 0	0006600	NEW DESIGN	ARES	061811'
MARK	ECN-NO.	REVISION RECORD	DRAWN	DATE

	UNLESS OTHERWISE SPECIFIED TOLERANCE:	SCALE	CHECKED
	Dimension Range Tolerance	1/1	APPROVED
X.X	±0.20	UNIT	
X.XX	±0.15	mm	
X.XXX	±0.10	SIZE	
ANGLE	±5°	A3	SHEET 1/1
Material/Plated/Notes	NAME		
SEE NOTE	1X1 RJ45 JACK, FTP		
Design No.	PART NO.	REV.	
	SEE NOTE	E	
	DOC. NO.	NN3J0A137	